

CORNER ANCHOR POINT

CORNER ANCHOR POINTS

NPK_L, NPK_T

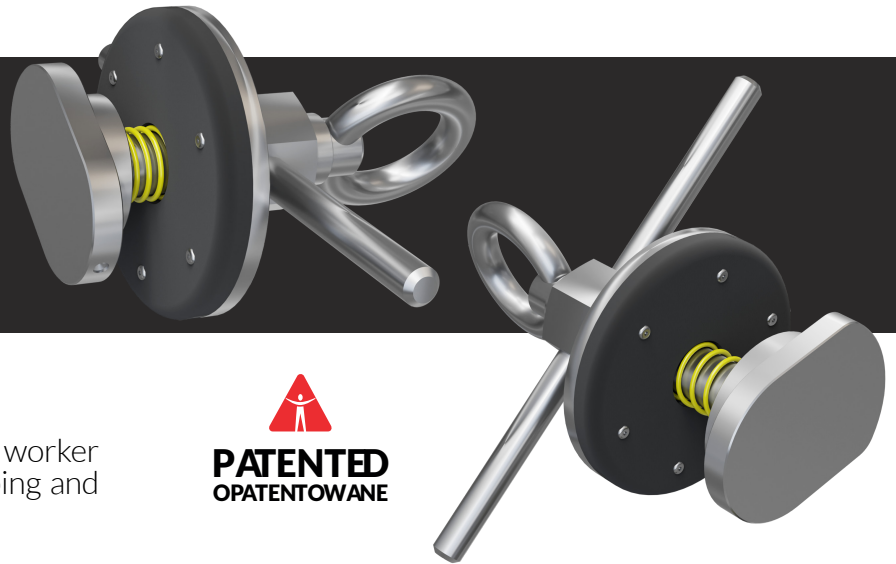

KEY FEATURES

The device is designed to protect the worker during the moving and handling of shipping and construction containers

The device complies with PN-EN 795B:2012, which means that it is a temporary anchor point installed in a way that prevents accidental disconnection of the point from the structural element to which it is mounted. However, it is possible to disconnect them intentionally from the structure; in this case, at least two separate and consecutive actions without the use of additional tools shall be performed.



Corner anchor points are available in two versions: NPK_L and NPK_T. The anchor points are designed to be installed in the transport slots located at the corners of the container. The corner anchor points are designed to be installed only in the side slots of container corners that comply with ISO 1161

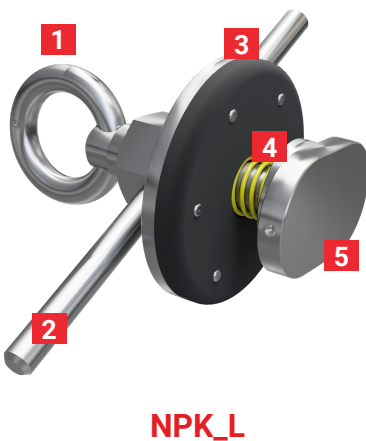

- 1** Eye of the anchor point
- 2** Pressure nut
- 3** Rubber washer
- 4** Extension spring
- 5** Lock

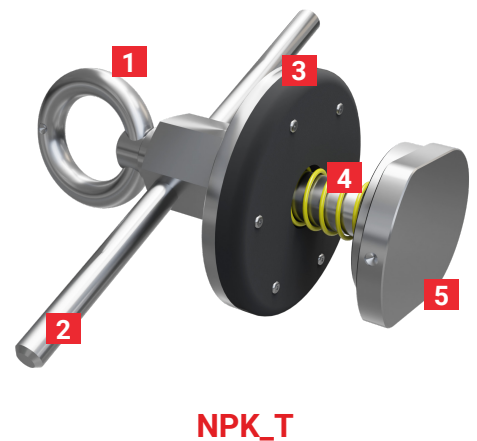

TECHNICAL FEATURES

STANDARD:	PN-EN 795:2012 typ B	TYPES AVAILABLE:	NPK_L, NPK_T	RISK CATEGORY:	III
SAFE WORKING LOAD:	100 kg	MAX. NO. OF USERS:	1 person		

TYPES AVAILABLE

Since the slots at container corners come in different shapes, two different versions of the corner anchor point have been developed.



NPK_L - for oval slots.



Wersja NPK_T - for shield-shaped slots.



INSTALLATION

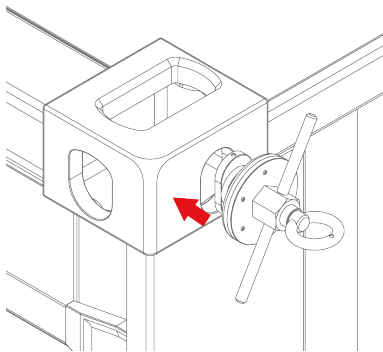

Place the lock of the NPK_L in the oval slot of the container corner.

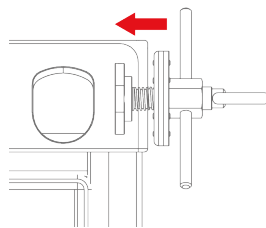

Turn the eye of the NPK to lock the anchor in the slot.

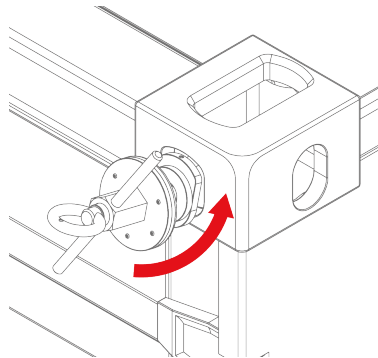

Place the lock of the NPK_T in the shield-shaped slot of the container corner.

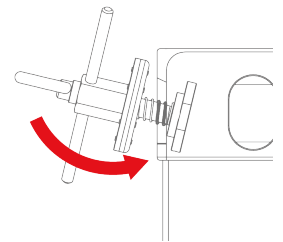

Tighten the pressure nut of the NPK.

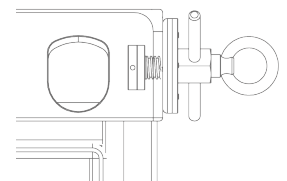
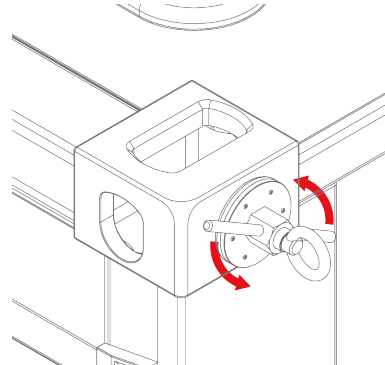
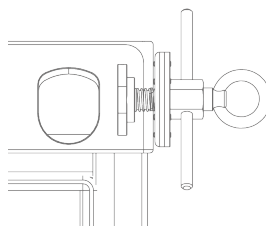
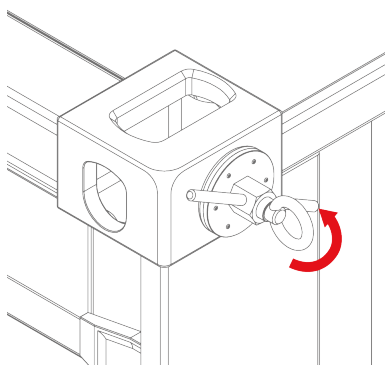

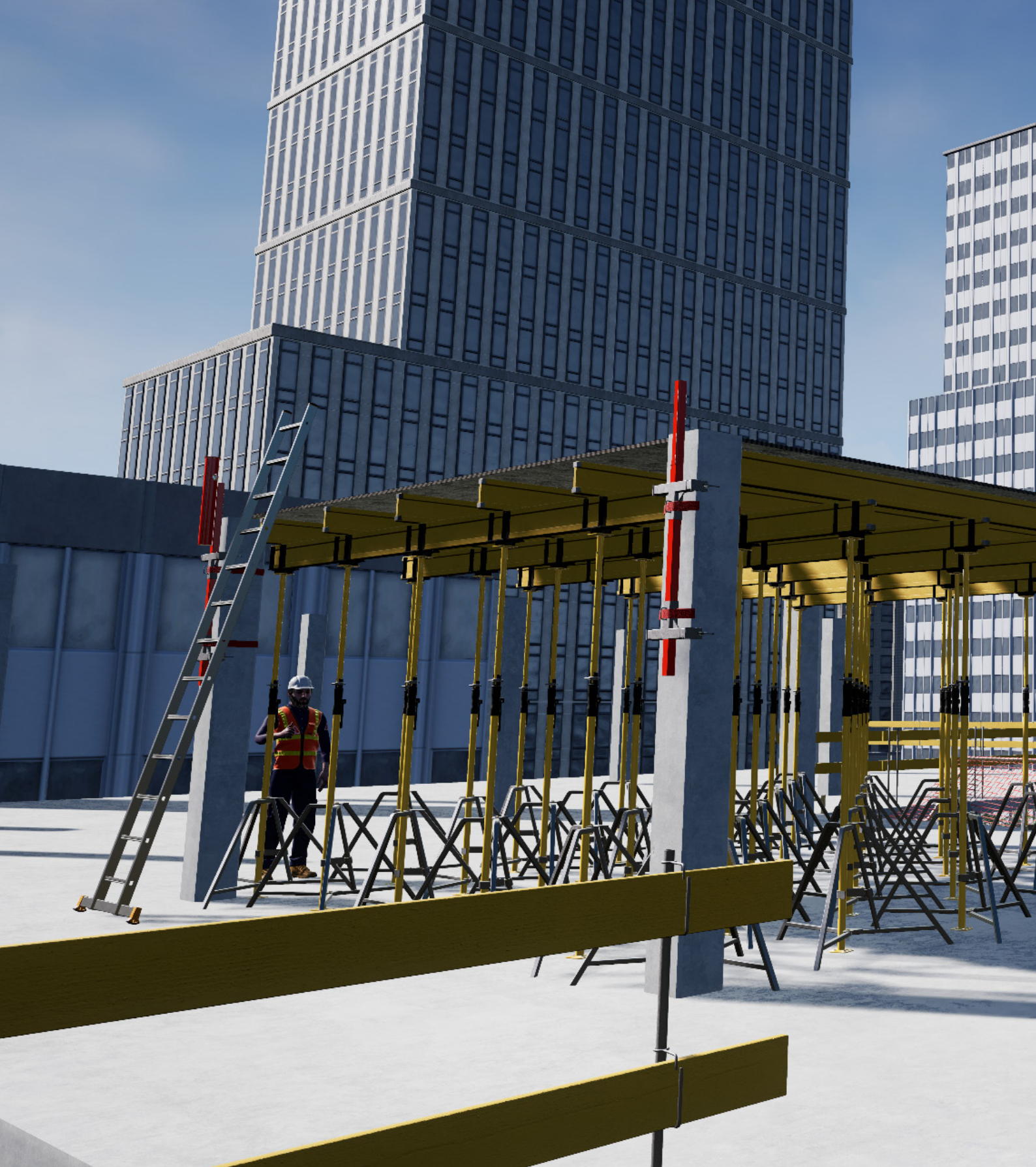

ROCK MASTER

CBR Rock Master Sp. z o. o. Sp. k.
ul. Królewska 94/11, 30-079 Kraków,
tel. +48 12 290 30 35;
e-mail: office@rockmaster.eu
NIP: 945-18-44-489

Centrum Badań i Rozwoju
ul. Sportowa 20, 32-083 Balice,
e-mail: cbr@rockmaster.eu

www.rockmaster.eu